

HVAC PLAN

PROJECT PROPOSED INSTITUTE OF DESIGN PLANNING & TECHNOLOGY (IDPT)

TITLE HVAC PLAN

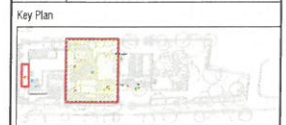

Stamp

REMARKS
 1. All dimensions are in meters unless otherwise specified.
 2. Key dimensions and the drawing should be checked & corrected in the interest of the client.
 3. The drafter is responsible for the accuracy of the drawing.
 4. No liability is accepted for the drawing, design or construction of the building.
 5. No part of this drawing shall be reproduced or used in any form without the prior written consent of the drafter.

LEGENDS

LEGENDS	LEGENDS
RWP- Rain Water Pipe	Brick Wall
RWS- Rain Water Sump	Concrete Wall
TR- Trap	Concrete Slab
UP/DN	Panel Block 1
Head Trip	Panel Block 2
Slipper Dividers	Concrete Column
Door	Fabrication Work
Window	Partition Marking
Ventilation	
Sliding Door	
Sink Below	
Sink Above	

Revision

Date	Revision details

CLIENT	SARVAJANIK EDUCATION SOCIETY
ARCHITECT	SCET Research & Design Cell (SRDC)
STRUCTURE CONSULTANT	BHAGAT & ASSOCIATES
LANDSCAPE	---
MEPP CONSULTANT	SHREEJI CONSULTANCY

SCALE	N.T.S	N		
P.No.	Scope	Stage	Dwg Code	Date
00	A	WD	FP/01	21.11.2025
Design & Drawing	Drawn By	Death By	Dwg. Checked By	Verified By
	Asha		Vishal Shah	
Team	Core Design Team			
SRDC	Peris Engineer, Divesh Rangrej	Design In-charge		Vishal Shah
	Mahesh Nagecha			

SCET RESEARCH & DESIGN CELL (SRDC)
 SCET & THE 538 Faculty of Architecture, SCET-Surat, R.K. Desai Marg, Athalwadi, Surat - 395001.

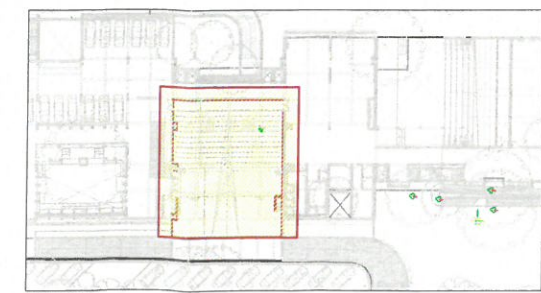

KEY PLAN

